

### 共模扼流滤波器

DC Common Mode (Line Filter)



#### 特性

Characteristics

巨大的共模阻抗Z

Enormous common mode impedance Z

小尺寸

Small dimensions

高电流额定值

High current ratings

#### 应用

Application

数据线

Data lines

电源系统

Power supply system

共模噪声的抑制

Suppression of common mode noise

#### 产品品名介绍

Product Number Structure

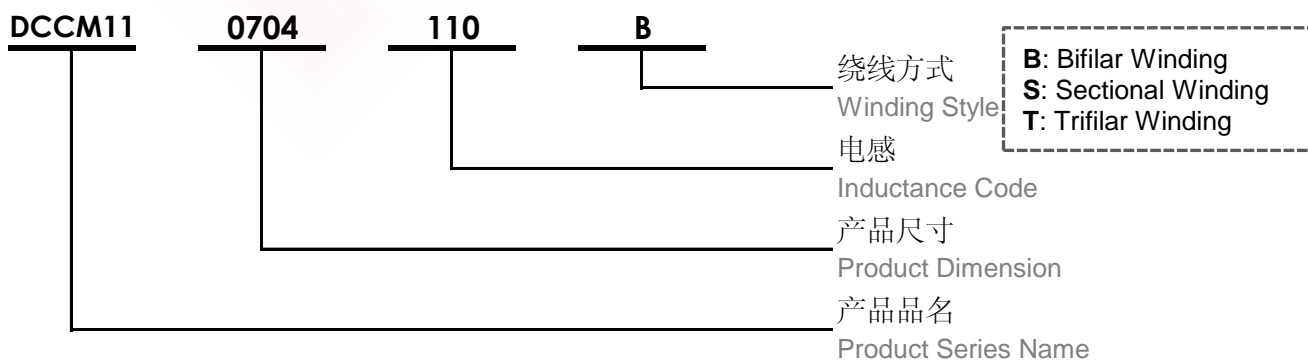



### 尺寸

Dimension (mm)

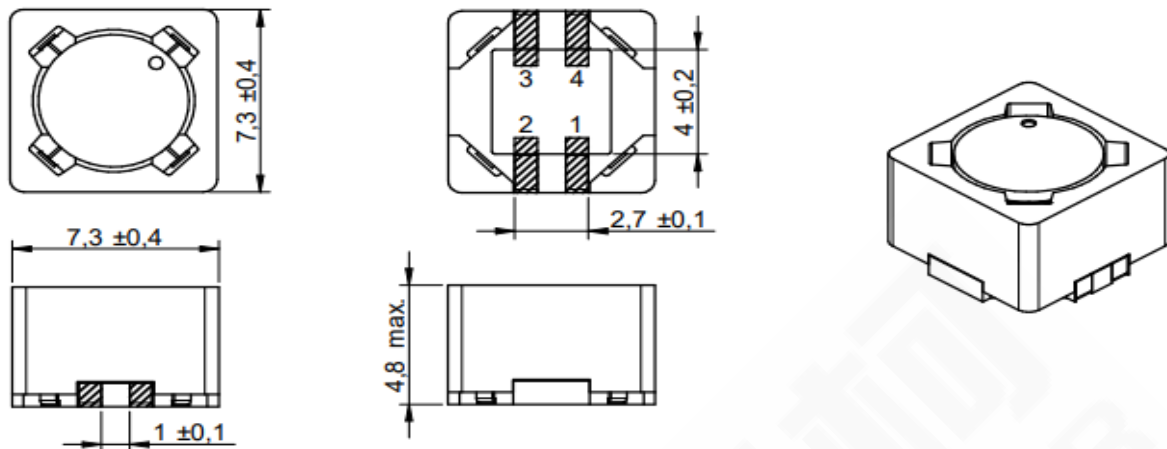

### 焊盘推荐

Land Pattern Recommended (mm)

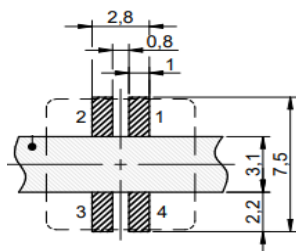

### 示意图

Schematics



### 电性特性

Electrical Properties

型号 Part No.	电感 Inductance $\mu\text{H}$	阻抗 Impedance $Z_{\text{max}} (\Omega)$	温升电流 Rated Current $I_{\text{r max 40}^\circ\text{C}} (\text{mA})$	直流电阻 DC Resistance $\text{DCR}_{\text{max}} (\Omega)$	绕线方式 Winding Style	包装数量 Packaging Qty pcs
DCCM11-0705-100B	10 $\pm 20\%$	10,000	1,100	0.120	Bifilar	1,000
DCCM11-0705-101B	100 $\pm 20\%$	50,000	350	0.950	Bifilar	1,000
DCCM11-0705-471B	470 $\pm 20\%$	100,000	150	4.300	Bifilar	1,000

### 测试状态

Test Condition

- ☆ 电感测试条件为 100kHz / 100mV (25°C)  
Inductance measure condition at 100kHz / 100mV (25°C)
- ☆ 速率电压: 80V  
Rated Voltage: 80V



### 典型阻抗特性

Typical Impedance Characteristics

#### DCCM11-0705-100B

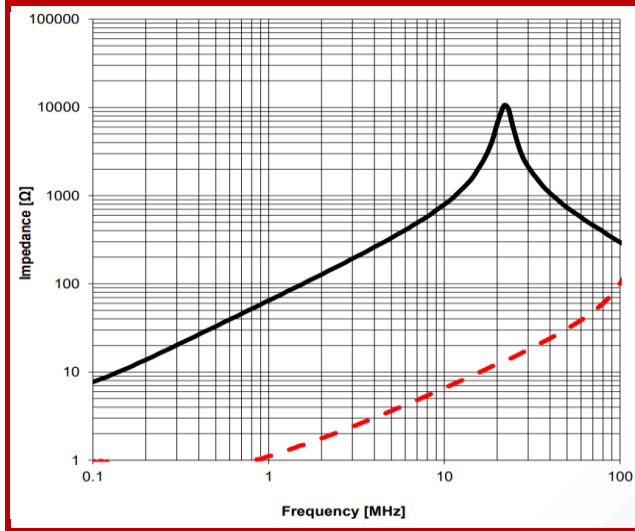

#### DCCM11-0705-101B

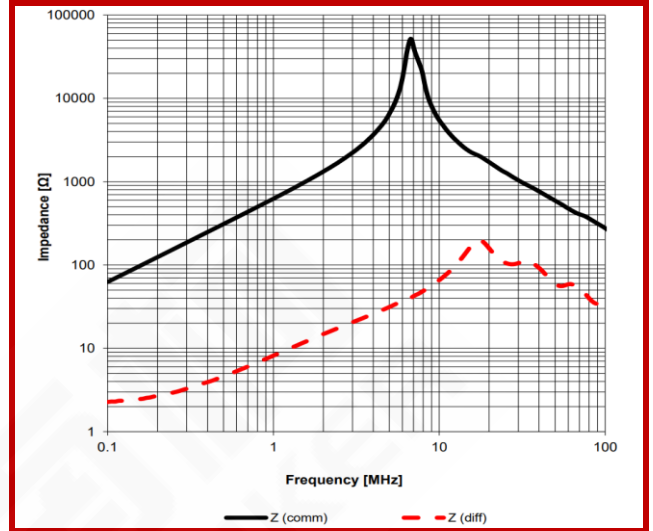

#### DCCM11-0705-471B

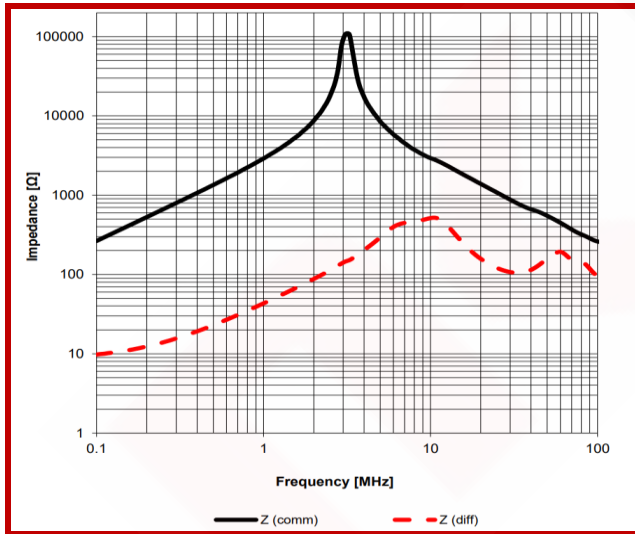



### 尺寸

Dimension (mm)

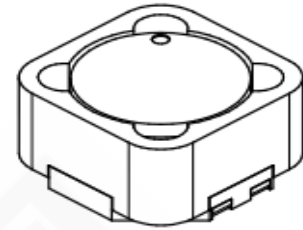
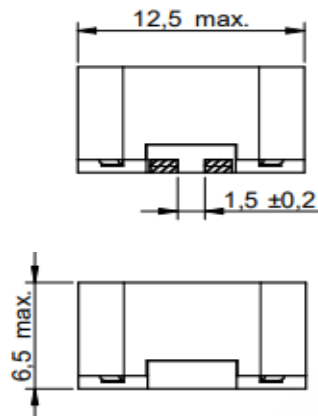
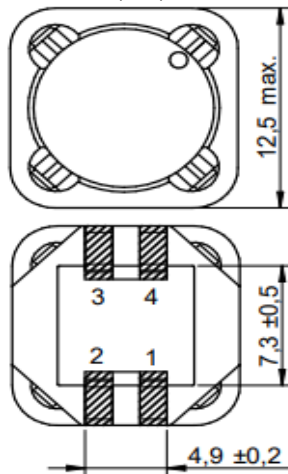

### 焊盘推荐

Land Pattern Recommended (mm)

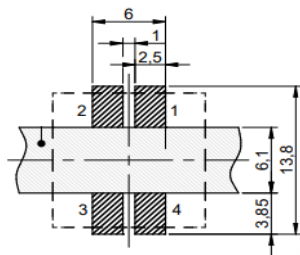

### 示意图

Schematics



### 电性特性

Electrical Properties

型号 Part No.	电感 Inductance μH	阻抗 Impedance Zmax (Ω)	温升电流 Rated Current I <sub>r</sub> max 40°C (mA)	直流电阻 DC Resistance DCRmax (Ω)	绕线方式 Winding Style	包装数量 Packaging Qty pcs
DCCM11-1307-1R0B	1.00 ±20%	1,600	4,750	0.01	Bifilar	500
DCCM11-1307-100B	10.00 ±20%	9,000	2,250	0.05	Bifilar	500
DCCM11-1307-101B	100 ±20%	40,000	900	0.28	Bifilar	500
DCCM11-1307-102B	1,000 ±20%	160,000	250	2.80	Bifilar	500

### 测试状态

Test Condition

- ☆ 电感测试条件为 100kHz / 100mV (25°C)  
Inductance measure condition at 100kHz / 100mV (25°C)
- ☆ 速率电压: 80V  
Rated Voltage: 80V



### 典型阻抗特性

Typical Impedance Characteristics

#### DCCM11-1307-1R0B

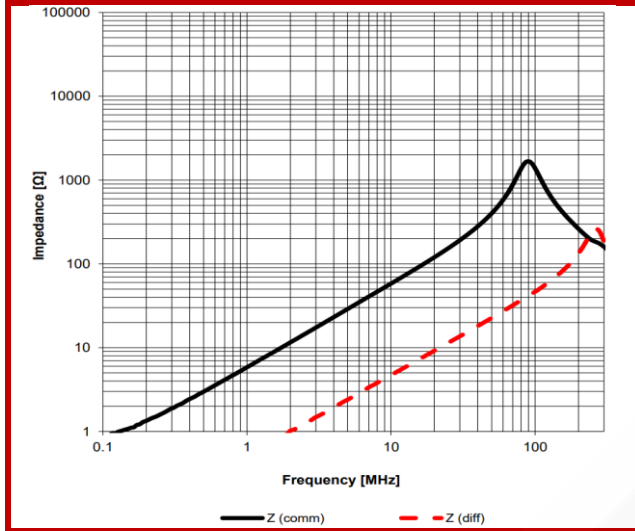

#### DCCM11-1307-100B

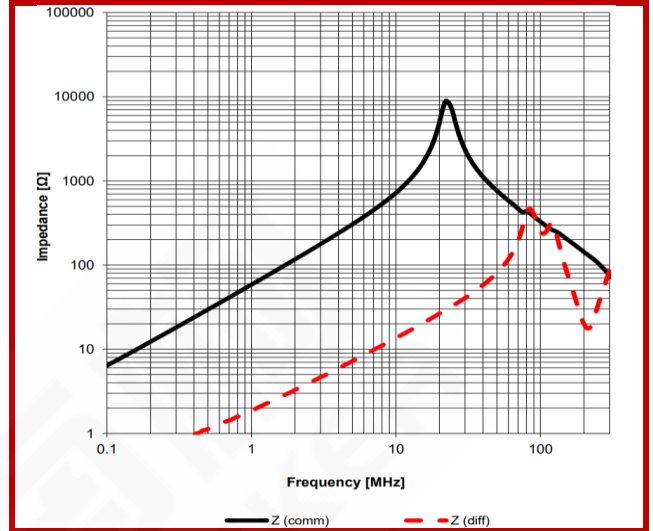

#### DCCM11-1307-101B

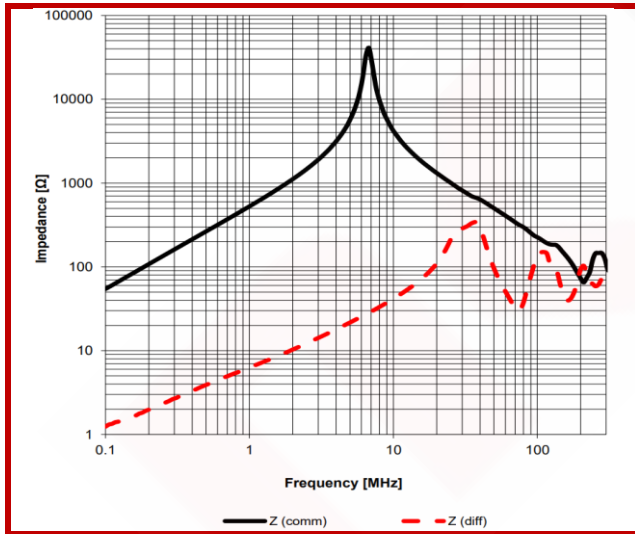

#### DCCM11-1307-102B

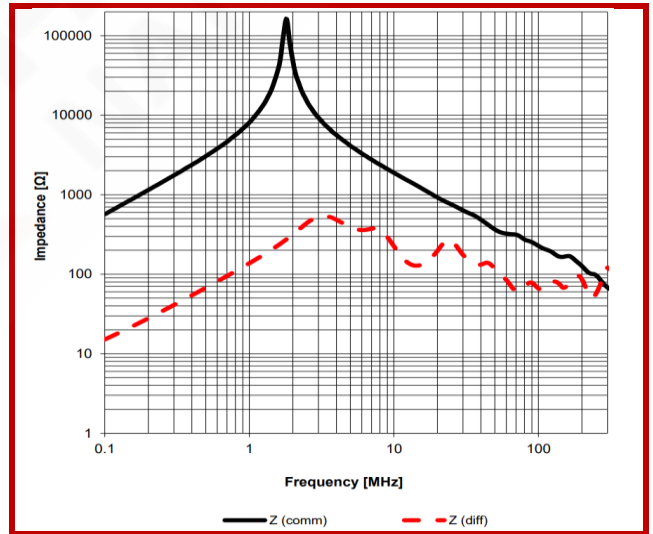



### 尺寸

Dimension (mm)

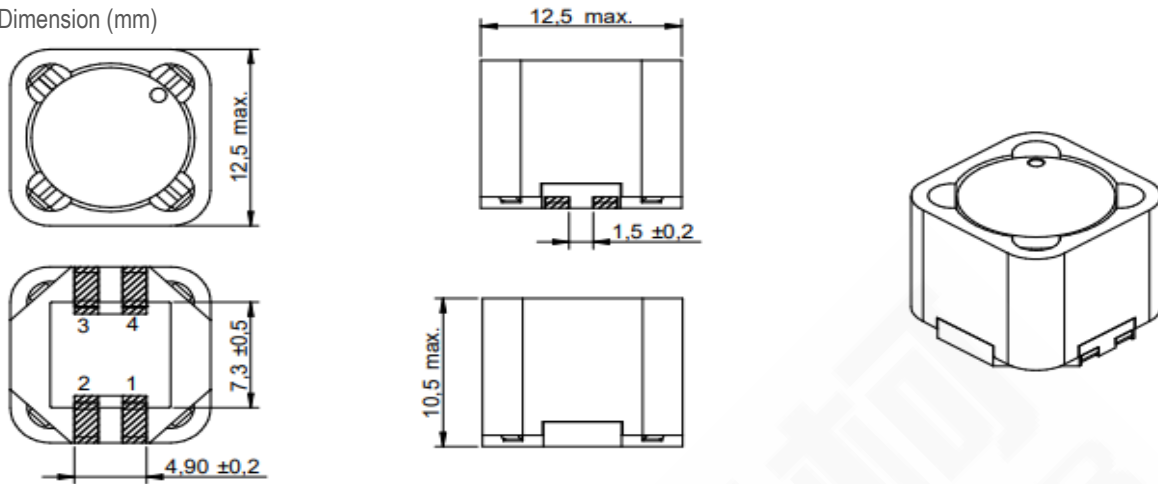

### 焊盘推荐

Land Pattern Recommended (mm)

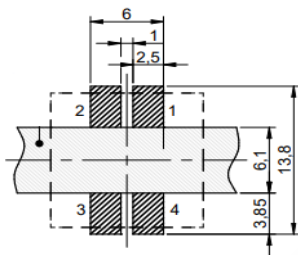

### 示意图

Schematics



### 电性特性

Electrical Properties

型号 Part No.	电感 Inductance μH	阻抗 Impedance Zmax (Ω)	温升电流 Rated Current I <sub>r</sub> max 40°C (mA)	直流电阻 DC Resistance DCRmax (Ω)	绕线方式 Winding Style	包装数量 Packaging Qty pcs
DCCM11-1311-100B	10 ±20%	10,000	2,750	0.04	Bifilar	250
DCCM11-1311-101B	100 ±20%	40,000	1,000	0.28	Bifilar	250
DCCM11-1311-102B	1,000 ±20%	160,000	300	2.50	Bifilar	250

### 测试状态

Test Condition

- ☆ 电感测试条件为 100kHz / 100mV (25°C)  
Inductance measure condition at 100kHz / 100mV (25°C)
- ☆ 工作温度: -40°C ~ +105°C  
Operating Temperature: -40°C ~ +105°C
- ☆ 速率电压: 80V  
Rated Voltage: 80V



### 典型阻抗特性

 Typical Impedance Characteristics

### DCCM11-1311-100B

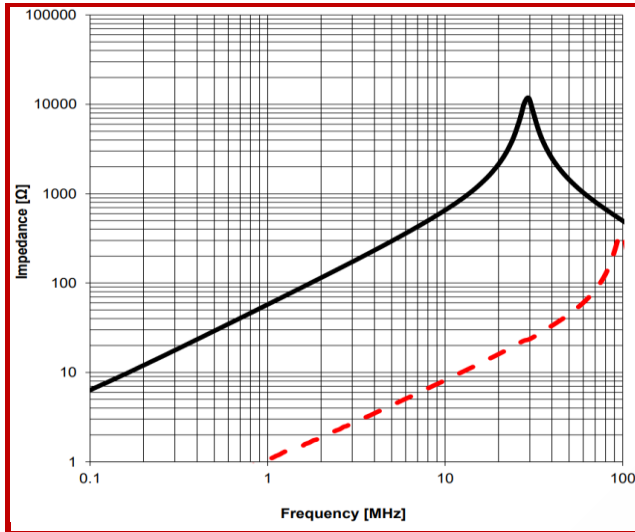

### DCCM11-1311-101B

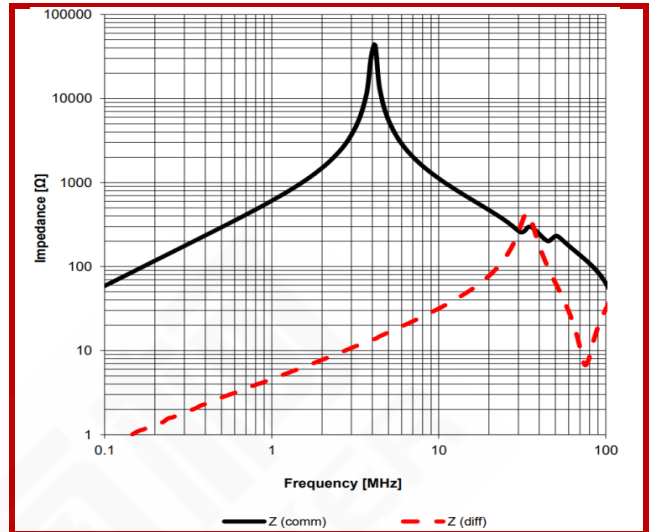

### DCCM11-1311-102B

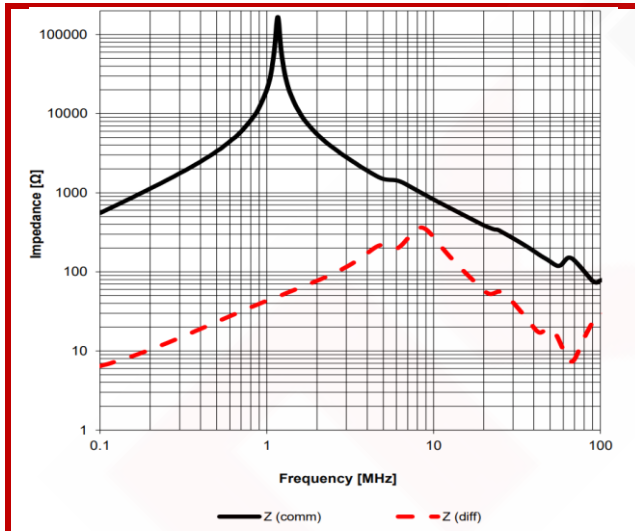

 回流焊曲线图

Classification Reflow Profile for SMT Components

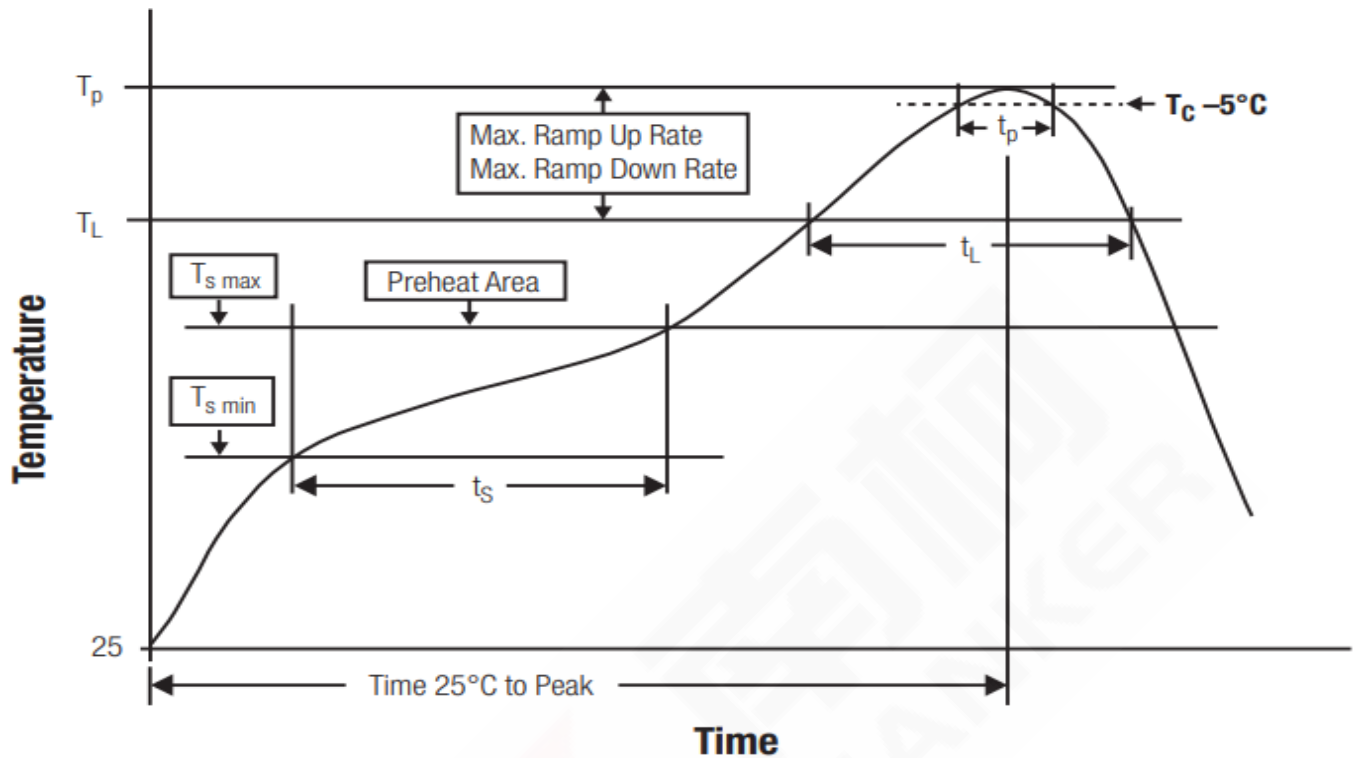

### 封装体峰值温度( $T_p$ )分类

Classification Reflow Soldering Profile:

	封装厚度 Package Thickness	封装体积 Package Volume		
		<350 mm <sup>3</sup>	350~2,000 mm <sup>3</sup>	>2,000 mm <sup>3</sup>
无铅装配 PB-Free Assembly	<1.60mm	260°C	260°C	260°C
	1.60~2.50mm	260°C	250°C	245°C
	>2.50mm	260°C	245°C	245°C

- ◆ 回流焊参照标准 IPC/JEDEC J-STD-020D。  
Reflow is refer to standard IPC/JEDEC J-STD-020D.