

插件共模电感

AC Common Mode



特性

Characteristics

高载流能力

High current carrying capacity

稳定的漏感用于差模滤波

Stable stray inductance for differential mode filtering

应用

Application

AC/DC转换器

AC/DC converter

高频DC/DC转换器

High frequency DC/DC converter

电源驱动的LED驱动器

Mains operated LED drivers

开关电源

Switched mode power supplies

产品品名介绍

Product Number Structure

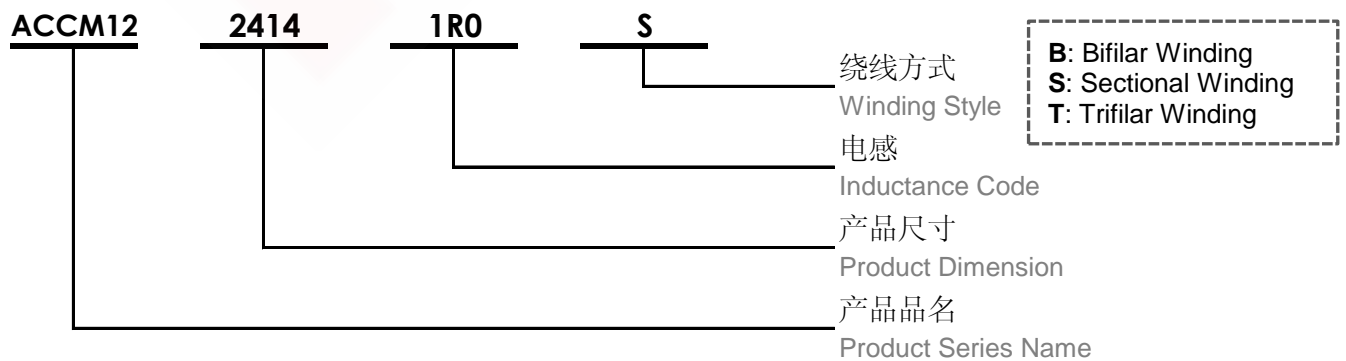

尺寸 Dimension (mm)

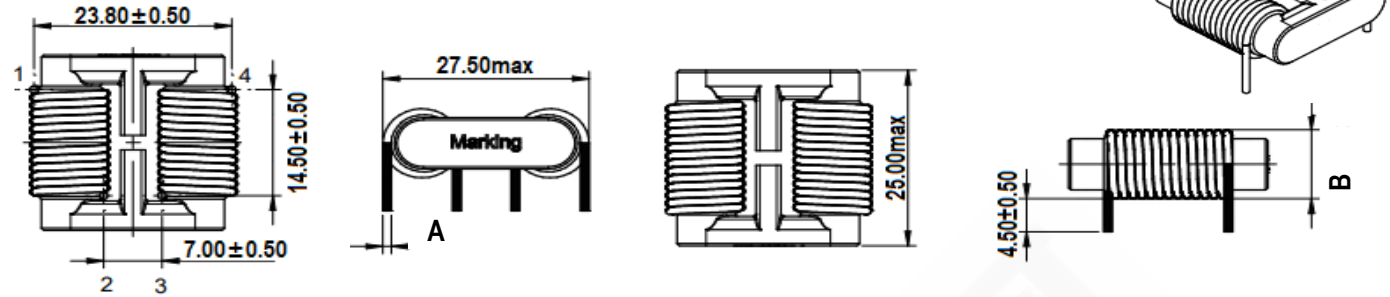

Part No.	Dimension A	Dimension B
ACCM12-2414-121S	Ø2.00±0.10	11.70max
ACCM12-2414-151S	Ø1.80±0.10	11.30max
ACCM12-2414-231S	Ø1.40±0.10	10.40max
ACCM12-2414-331S	Ø1.20±0.10	10.00max
ACCM12-2414-451S	Ø1.00±0.10	9.70max

焊盘推荐 Land Pattern Recommended (mm)



示意图 Schematics



Part No	ACCM12-2414-121S	ACCM12-2414-151S	ACCM12-2414-231S	ACCM12-2414-331S	ACCM12-2414-451S
Dimension C	Ø2.30mm	Ø2.10mm	Ø1.70mm	Ø1.50mm	Ø1.30mm

电性特性 Electrical Properties

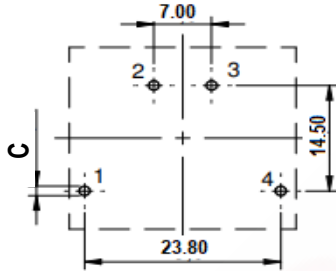
型号 Part No.	电感 Inductance µH	温升电流 Rated Current I _r 60°C max(A)	直流电阻 DC Resistance DCR max (mΩ)	漏感 Leakage Inductance 10kHz/100mV (µH) typ	绕线方式 Winding Style	包装数量 Packaging Qty pcs
ACCM12-2414-121S	120 ±40%	23.50	1.40	4.10	Sectional	300
ACCM12-2414-151S	150 ±40%	20.00	1.90	5.60	Sectional	300
ACCM12-2414-231S	230 ±40%	16.00	3.60	8.70	Sectional	300
ACCM12-2414-331S	330 ±40%	12.00	6.00	12.60	Sectional	300
ACCM12-2414-451S	450 ±40%	9.50	9.60	17.60	Sectional	300

测试状态

Test Condition

- ☆ 电感测试条件为 10kHz / 0.10mV (25°C)
Inductance measure condition at 10kHz / 0.10mA (25°C)
- ☆ 工作温度: -40°C ~ +115°C
Operating Temperature: -40°C ~ +115°C
- ☆ 额定电压 50Hz: 250V
Rated Voltage 50Hz: 250V

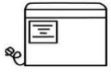

典型阻抗特性

Typical Impedance Characteristics

ACCM12-2414-121S

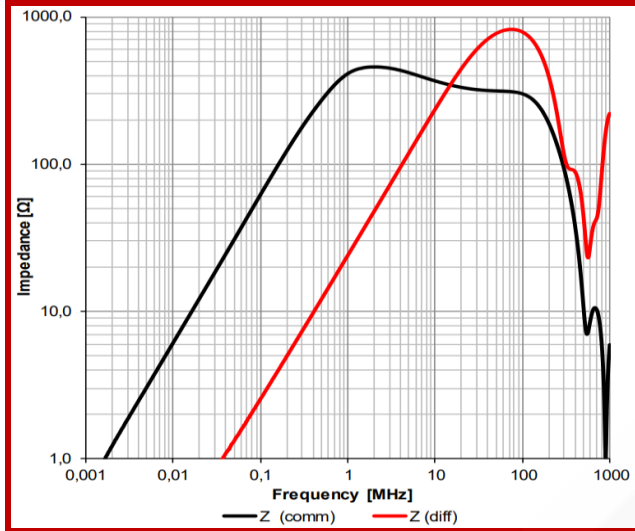

ACCM12-2414-151S

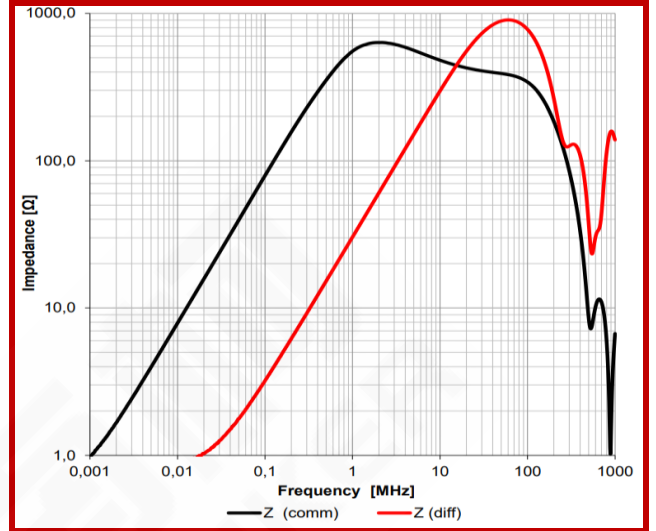

ACCM12-2414-231S

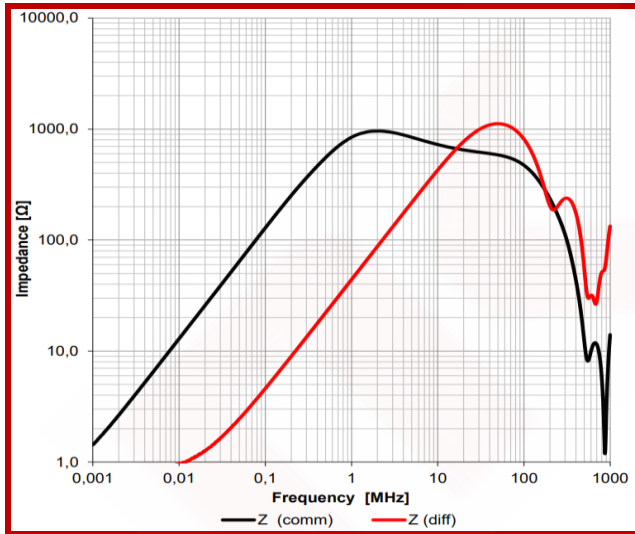

ACCM12-2414-331S

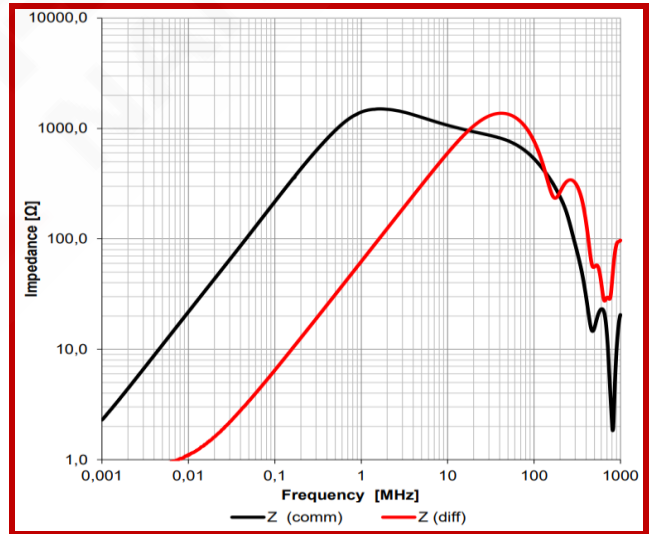

ACCM12-2414-451S

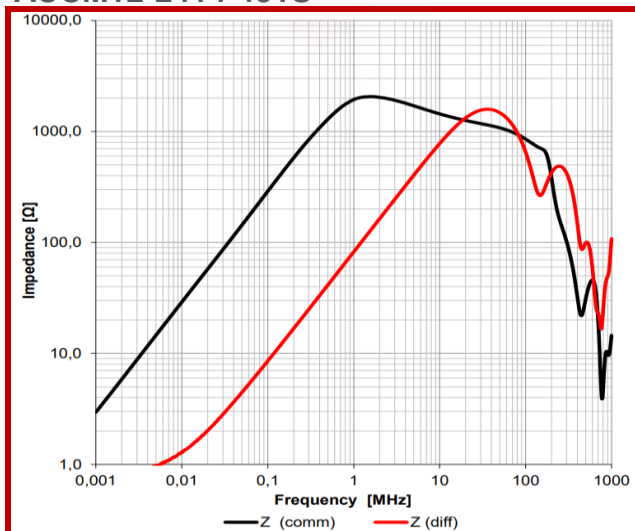



波峰焊线图

Classification Wave Soldering Profile

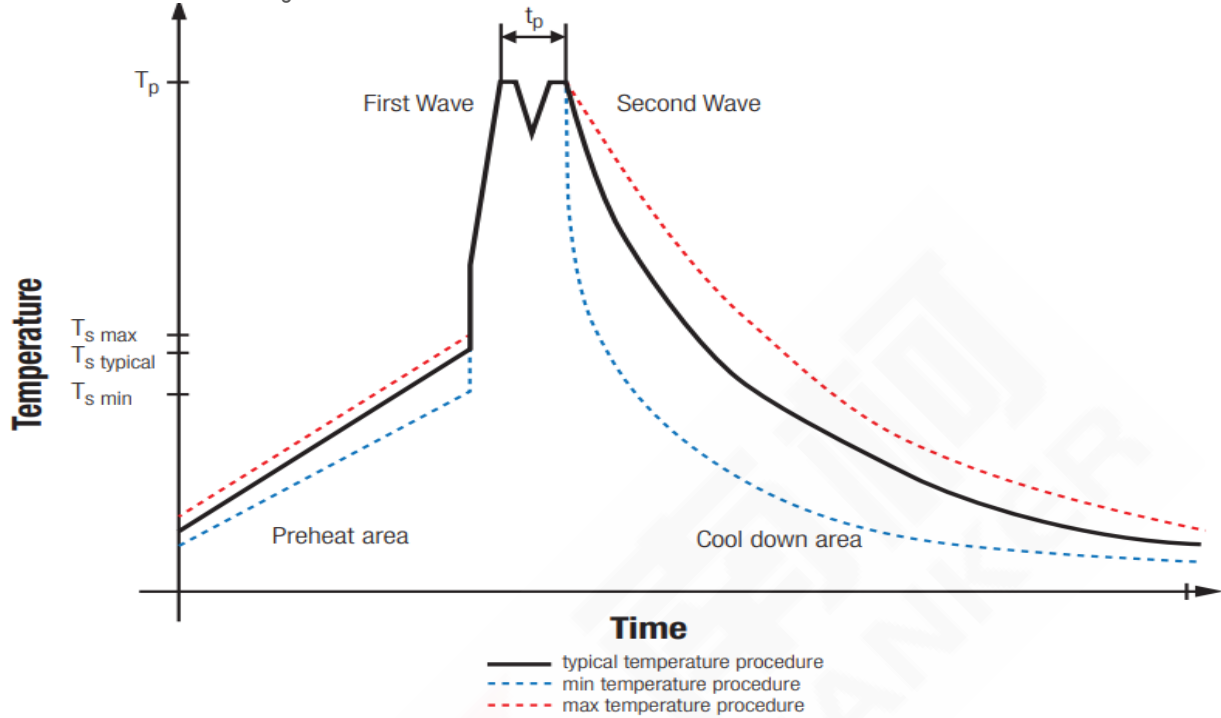

封装体峰值温度(T_p)分类

Classification Reflow Soldering Profile:

Profile Feature		Pb-Free Assembly	Sn-Pb Assembly
Preheat Temperature Min	$T_{s\ min}$	100°C	100°C
Preheat Temperature Typical	$T_{s\ typical}$	120°C	120°C
Preheat Temperature Max	$T_{s\ max}$	130°C	130°C
Preheat Time t_s from $T_{s\ min}$ to $T_{s\ max}$	t_s	70 seconds	70 seconds
Ramp-up Rate	ΔT	150°C max	150°C max
Peak Temperature	T_p	250°C ~ 260°C	235°C ~ 260°C
Time of actual peak temperature	t_p	max. 10 seconds max. 5 seconds each wave	max. 10 seconds max. 5 seconds each wave
Ramp-down Rate, Min		~ 2K/seconds	~ 2K/seconds
Ramp-down Rate, Typical		~3.5K/seconds	~3.5K/seconds
Ramp-down Rate, Max		5K/seconds	5K/seconds
Time 25°C to 25°C		4 minutes	4 minutes

* 波峰焊参照标准EN61760-1:2006。

Wave Soldering is refer to standard EN61760-1:2006