

Pluggable

Screw type plug

Plug-in system terminal block

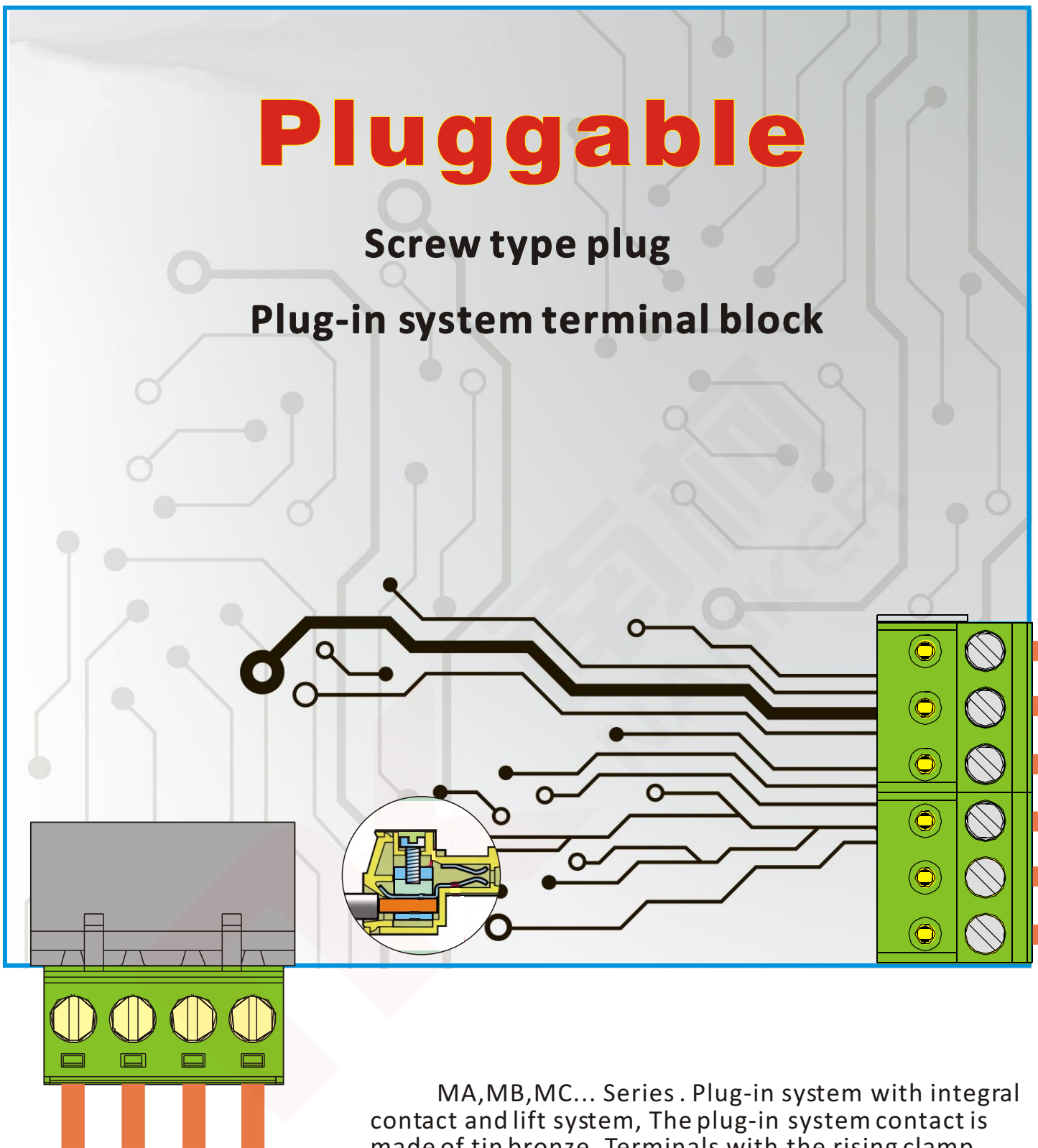

Nomenclature rules

Example:

MA ST 350 xx x xxx
① ② ③ ④ ⑤ ⑥

- ① Type
- ② Product style
- ③ Pitch
- ④ Poles
- ⑤ Color
- ⑥ Custom

Color

0	Black	5	Green
1	Brown	6	Blue
2	Red	7	Violet
3	Orange	8	Dark grey
4	Yellow	9	White

MA,MB,MC... Series. Plug-in system with integral contact and lift system, The plug-in system contact is made of tin bronze. Terminals with the rising clamp system incorporate an integral sold-ering pin made of special grade brass. Plating consists of an nickel. ribs across the contact area of the terminal and the special shape of the base of the terminal body ensure that the wires are securely clamped. Thereby guaranteeing good contact, as well as holding the wire securely and without damage.

The series are extremely suitable for industrial control ,Automation control and security industry.



MAST350 Pitch 3.5mm
Poles 2p~24p
Connection point up type, without flange

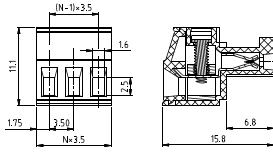

MBSR350 Pitch 3.5mm
Poles 2p~24p
Plug, hook on entry side, without flange

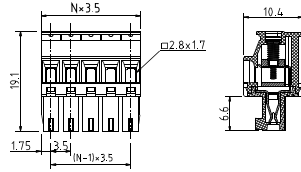

MBSW350 Pitch 3.5mm
Poles 2p~24p
Plug, hook on back side, without flange

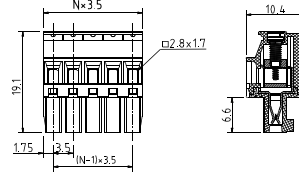

Technical data				
Approval				
Technical data(UL/cUL)	Use Group	B	C	D
Nominal voltage (V)		300	-	300
Nominal current (A)		8	-	8
Connection capacity(AWG)		30-16	-	30-16
Technical data in accordance with IEC and VDE				
Rated insulation voltage at pollution degree 2 (V)		160		
Rated current/conductor cross-section (A/mm ²)		8/1.5		
Solid/stranded(mm ²)		0.14-1.5/0.14-1.5		
Surge voltage category/pollution degree		III/3	III/2	II/2
Rated insulation voltage(V)		160	160	320
Rated surge voltage(kV)		2.5	2.5	2.5
General data				
Stripping length(mm)		6-7		
Screw thread		M2		
Tightening torque(Nm)		0.20-0.25		
Insulation material group		PA 66 I V0		

Technical data				
Approval				
Technical data(UL/cUL)	Use Group	B	C	D
Nominal voltage (V)		300	-	300
Nominal current (A)		8	-	8
Connection capacity(AWG)		30-16	-	30-16
Technical data in accordance with IEC				
Rated insulation voltage at pollution degree 2 (V)		160		
Rated current/conductor cross-section (A/mm ²)		8/1.5		
Solid/stranded(mm ²)		0.14-1.5/0.14-1.5		
Surge voltage category/pollution degree		III/3	III/2	II/2
Rated insulation voltage(V)		160	160	320
Rated surge voltage(kV)		2.5	2.5	2.5
General data				
Stripping length(mm)		6-7		
Screw thread		M2		
Tightening torque(Nm)		0.20-0.25		
Insulation material group		PA 66 I V0		

Technical data				
Approval				
Technical data(UL/cUL)	Use Group	B	C	D
Nominal voltage (V)		300	-	300
Nominal current (A)		8	-	8
Connection capacity(AWG)		30-16	-	30-16
Technical data in accordance with IEC				
Rated insulation voltage at pollution degree 2 (V)		160		
Rated current/conductor cross-section (A/mm ²)		8/1.5		
Solid/stranded(mm ²)		0.14-1.5/0.14-1.5		
Surge voltage category/pollution degree		III/3	III/2	II/2
Rated insulation voltage(V)		160	160	320
Rated surge voltage(kV)		2.5	2.5	2.5
General data				
Stripping length(mm)		6-7		
Screw thread		M2		
Tightening torque(Nm)		0.20-0.25		
Insulation material group		PA 66 I V0		



MAFT350 Pitch 3.5mm
Poles 2p~24p
Connection point up type, with screw flange

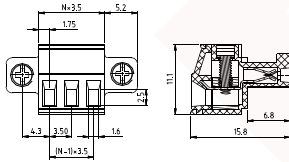

MBFR350 Pitch 3.5mm
Poles 2p~24p
Plug, hook on entry side, with screw flange

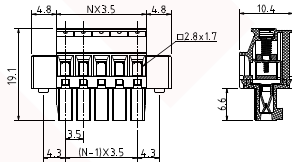

MBFW350 Pitch 3.5mm
Poles 2p~24p
Plug, hook on back side, with screw flange

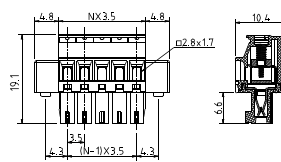

Technical data				
Approval				
Technical data(UL/cUL)	Use Group	B	C	D
Nominal voltage (V)		300	-	300
Nominal current (A)		8	-	8
Connection capacity(AWG)		30-16	-	30-16
Technical data in accordance with IEC and VDE				
Rated insulation voltage at pollution degree 2 (V)		160		
Rated current/conductor cross-section (A/mm ²)		8/1.5		
Solid/stranded(mm ²)		0.14-1.5/0.14-1.5		
Surge voltage category/pollution degree		III/3	III/2	II/2
Rated insulation voltage(V)		160	160	320
Rated surge voltage(kV)		2.5	2.5	2.5
General data				
Stripping length(mm)		6-7		
Screw thread		M2		
Tightening torque(Nm)		0.20-0.25		
Insulation material group		PA 66 I V0		

Technical data				
Approval				
Technical data(UL/cUL)	Use Group	B	C	D
Nominal voltage (V)		300	-	300
Nominal current (A)		8	-	8
Connection capacity(AWG)		30-16	-	30-16
Technical data in accordance with IEC				
Rated insulation voltage at pollution degree 2 (V)		160		
Rated current/conductor cross-section (A/mm ²)		8/1.5		
Solid/stranded(mm ²)		0.14-1.5/0.14-1.5		
Surge voltage category/pollution degree		III/3	III/2	II/2
Rated insulation voltage(V)		160	160	320
Rated surge voltage(kV)		2.5	2.5	2.5
General data				
Stripping length(mm)		6-7		
Screw thread		M2		
Tightening torque(Nm)		0.20-0.25		
Insulation material group		PA 66 I V0		

Technical data				
Approval				
Technical data(UL/cUL)	Use Group	B	C	D
Nominal voltage (V)		300	-	300
Nominal current (A)		8	-	8
Connection capacity(AWG)		30-16	-	30-16
Technical data in accordance with IEC				
Rated insulation voltage at pollution degree 2 (V)		160		
Rated current/conductor cross-section (A/mm ²)		8/1.5		
Solid/stranded(mm ²)		0.14-1.5/0.14-1.5		
Surge voltage category/pollution degree		III/3	III/2	II/2
Rated insulation voltage(V)		160	160	320
Rated surge voltage(kV)		2.5	2.5	2.5
General data				
Stripping length(mm)		6-7		
Screw thread		M2		
Tightening torque(Nm)		0.20-0.25		
Insulation material group		PA 66 I V0		



MAST381 Pitch 3.81mm
Poles 2p~24p
Connection point up type, without flange

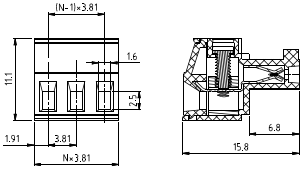

MBSR381 Pitch 3.81mm
Poles 2p~24p
Plug, hook on entry side, without flange

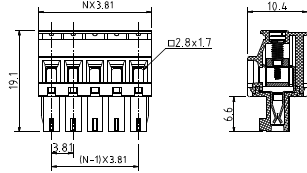

MBSW381 Pitch 3.81mm
Poles 2p~24p
Plug, hook on back side, without flange

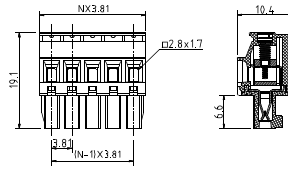

Technical data			
Approval			
Technical data(UL/cUL)	Use Group	B	C D
Nominal voltage (V)	300	-	300
Nominal current (A)	8	-	8
Connection capacity(AWG)	30-16	-	30-16
Technical data in accordance with IEC and VDE			
Rated insulation voltage at pollution degree 2 (V)	160		
Rated current/conductor cross-section (A/mm ²)	8/1.5		
Solid/stranded(mm ²)	0.14-1.5/0.14-1.5		
Surge voltage category/pollution degree	III/3	III/2	II/2
Rated insulation voltage(V)	160	160	320
Rated surge voltage(kV)	2.5	2.5	2.5
General data			
Stripping length(mm)	6-7		
Screw thread	M2		
Tightening torque(Nm)	0.20-0.25		
Insulation material group	PA 66 I V0		

Technical data			
Approval			
Technical data(UL/cUL)	Use Group	B	C D
Nominal voltage (V)	300	-	300
Nominal current (A)	8	-	8
Connection capacity(AWG)	30-16	-	30-16
Technical data in accordance with IEC			
Rated insulation voltage at pollution degree 2 (V)	160		
Rated current/conductor cross-section (A/mm ²)	8/1.5		
Solid/stranded(mm ²)	0.14-1.5/0.14-1.5		
Surge voltage category/pollution degree	III/3	III/2	II/2
Rated insulation voltage(V)	160	160	320
Rated surge voltage(kV)	2.5	2.5	2.5
General data			
Stripping length(mm)	6-7		
Screw thread	M2		
Tightening torque(Nm)	0.20-0.25		
Insulation material group	PA 66 I V0		

Technical data			
Approval			
Technical data(UL/cUL)	Use Group	B	C D
Nominal voltage (V)	300	-	300
Nominal current (A)	8	-	8
Connection capacity(AWG)	30-16	-	30-16
Technical data in accordance with IEC			
Rated insulation voltage at pollution degree 2 (V)	160		
Rated current/conductor cross-section (A/mm ²)	8/1.5		
Solid/stranded(mm ²)	0.14-1.5/0.14-1.5		
Surge voltage category/pollution degree	III/3	III/2	II/2
Rated insulation voltage(V)	160	160	320
Rated surge voltage(kV)	2.5	2.5	2.5
General data			
Stripping length(mm)	6-7		
Screw thread	M2		
Tightening torque(Nm)	0.20-0.25		
Insulation material group	PA 66 I V0		

Technical data			
Approval			
Technical data(UL/cUL)	Use Group	B	C D
Nominal voltage (V)	300	-	300
Nominal current (A)	8	-	8
Connection capacity(AWG)	30-16	-	30-16
Technical data in accordance with IEC			
Rated insulation voltage at pollution degree 2 (V)	160		
Rated current/conductor cross-section (A/mm ²)	8/1.5		
Solid/stranded(mm ²)	0.14-1.5/0.14-1.5		
Surge voltage category/pollution degree	III/3	III/2	II/2
Rated insulation voltage(V)	160	160	320
Rated surge voltage(kV)	2.5	2.5	2.5
General data			
Stripping length(mm)	6-7		
Screw thread	M2		
Tightening torque(Nm)	0.20-0.25		
Insulation material group	PA 66 I V0		



MAFT381 Pitch 3.81mm
Poles 2p~24p
Connection point up type, with screw flange

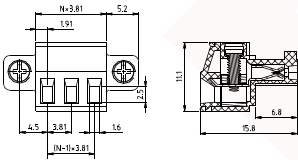

MBFR381 Pitch 3.81mm
Poles 2p~24p
Plug, hook on entry side, with screw flange

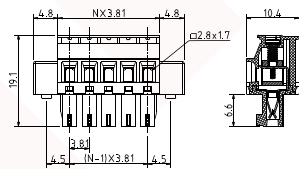

MBFW381 Pitch 3.81mm
Poles 2p~24p
Plug, hook on back side, with screw flange

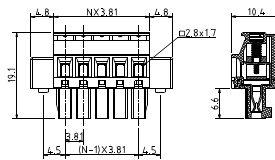

Technical data			
Approval			
Technical data(UL/cUL)	Use Group	B	C D
Nominal voltage (V)	300	-	300
Nominal current (A)	8	-	8
Connection capacity(AWG)	30-16	-	30-16
Technical data in accordance with IEC and VDE			
Rated insulation voltage at pollution degree 2 (V)	160		
Rated current/conductor cross-section (A/mm ²)	8/1.5		
Solid/stranded(mm ²)	0.14-1.5/0.14-1.5		
Surge voltage category/pollution degree	III/3	III/2	II/2
Rated insulation voltage(V)	160	160	320
Rated surge voltage(kV)	2.5	2.5	2.5
General data			
Stripping length(mm)	6-7		
Screw thread	M2		
Tightening torque(Nm)	0.20-0.25		
Insulation material group	PA 66 I V0		

Technical data			
Approval			
Technical data(UL/cUL)	Use Group	B	C D
Nominal voltage (V)	300	-	300
Nominal current (A)	8	-	8
Connection capacity(AWG)	30-16	-	30-16
Technical data in accordance with IEC			
Rated insulation voltage at pollution degree 2 (V)	160		
Rated current/conductor cross-section (A/mm ²)	8/1.5		
Solid/stranded(mm ²)	0.14-1.5/0.14-1.5		
Surge voltage category/pollution degree	III/3	III/2	II/2
Rated insulation voltage(V)	160	160	320
Rated surge voltage(kV)	2.5	2.5	2.5
General data			
Stripping length(mm)	6-7		
Screw thread	M2		
Tightening torque(Nm)	0.20-0.25		
Insulation material group	PA 66 I V0		

Technical data			
Approval			
Technical data(UL/cUL)	Use Group	B	C D
Nominal voltage (V)	300	-	300
Nominal current (A)	8	-	8
Connection capacity(AWG)	30-16	-	30-16
Technical data in accordance with IEC			
Rated insulation voltage at pollution degree 2 (V)	160		
Rated current/conductor cross-section (A/mm ²)	8/1.5		
Solid/stranded(mm ²)	0.14-1.5/0.14-1.5		
Surge voltage category/pollution degree	III/3	III/2	II/2
Rated insulation voltage(V)	160	160	320
Rated surge voltage(kV)	2.5	2.5	2.5
General data			
Stripping length(mm)	6-7		
Screw thread	M2		
Tightening torque(Nm)	0.20-0.25		
Insulation material group	PA 66 I V0		

Technical data			
Approval			
Technical data(UL/cUL)	Use Group	B	C D
Nominal voltage (V)	300	-	300
Nominal current (A)	8	-	8
Connection capacity(AWG)	30-16	-	30-16
Technical data in accordance with IEC			
Rated insulation voltage at pollution degree 2 (V)	160		
Rated current/conductor cross-section (A/mm ²)	8/1.5		
Solid/stranded(mm ²)	0.14-1.5/0.14-1.5		
Surge voltage category/pollution degree	III/3	III/2	II/2
Rated insulation voltage(V)	160	160	320
Rated surge voltage(kV)	2.5	2.5	2.5
General data			
Stripping length(mm)	6-7		
Screw thread	M2		
Tightening torque(Nm)	0.20-0.25		
Insulation material group	PA 66 I V0		



MASD500 Pitch 5.0mm
Poles 2p~24p
Connection point down type

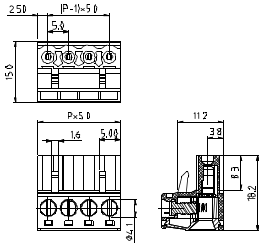

MAST500 Pitch 5.0mm
Poles 2p~24p
Connection point up type

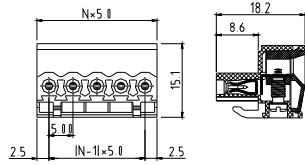

MBSR500 Pitch 5.0mm
Poles 2p~24p
Plug, hook on entry side, without flange

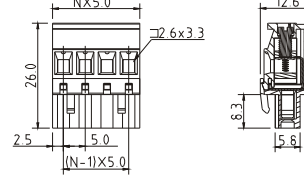

MBSW500 Pitch 5.0mm
Poles 2p~24p
Plug, hook on back side, without flange

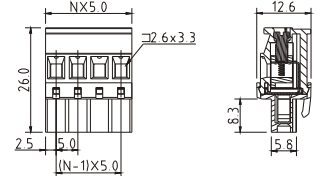

Technical data				
Approval				
Technical data(UL/cUL)	Use Group	B	C	D
Nominal voltage (V)		300	-	300
Nominal current (A)		15	-	10
Connection capacity(AWG)		30-12	-	30-12
Technical data in accordance with IEC and VDE				
Rated insulation voltage at pollution degree 2 (V)			320	
Rated current/conductor cross-section (A/mm ²)			12/2.5	
Solid/stranded(mm ²)		0.2-2.5/0.2-2.5		
Surge voltage category/pollution degree		III/3	III/2	II/2
Rated insulation voltage(V)		250	320	630
Rated surge voltage(kV)		4	4	4
General data				
Stripping length(mm)		7-8		
Screw thread		M3		
Tightening torque(Nm)		0.5-0.6		
Insulation material group		PA 66 I V0		

Technical data				
Approval				
Technical data(UL/cUL)	Use Group	B	C	D
Nominal voltage (V)		300	-	300
Nominal current (A)		15	-	10
Connection capacity(AWG)		30-12	-	30-12
Technical data in accordance with IEC				
Rated insulation voltage at pollution degree 2 (V)			320	
Rated current/conductor cross-section (A/mm ²)			12/2.5	
Solid/stranded(mm ²)		0.2-2.5/0.2-2.5		
Surge voltage category/pollution degree		III/3	III/2	II/2
Rated insulation voltage(V)		250	320	630
Rated surge voltage(kV)		4	4	4
General data				
Stripping length(mm)		7-8		
Screw thread		M3		
Tightening torque(Nm)		0.5-0.6		
Insulation material group		PA 66 I V0		

Technical data				
Approval				
Technical data(UL/cUL)	Use Group	B	C	D
Nominal voltage (V)		300	-	300
Nominal current (A)		15	-	10
Connection capacity(AWG)		30-12	-	30-12
Technical data in accordance with IEC and VDE				
Rated insulation voltage at pollution degree 2 (V)			320	
Rated current/conductor cross-section (A/mm ²)			12/2.5	
Solid/stranded(mm ²)		0.2-2.5/0.2-2.5		
Surge voltage category/pollution degree		III/3	III/2	II/2
Rated insulation voltage(V)		250	320	630
Rated surge voltage(kV)		4	4	4
General data				
Stripping length(mm)		6-7		
Screw thread		M3		
Tightening torque(Nm)		0.5-0.6		
Insulation material group		PA 66 I V0		

Technical data				
Approval				
Technical data(UL/cUL)	Use Group	B	C	D
Nominal voltage (V)		300	-	300
Nominal current (A)		15	-	10
Connection capacity(AWG)		30-12	-	30-12
Technical data in accordance with IEC and VDE				
Rated insulation voltage at pollution degree 2 (V)			320	
Rated current/conductor cross-section (A/mm ²)			12/2.5	
Solid/stranded(mm ²)		0.2-2.5/0.2-2.5		
Surge voltage category/pollution degree		III/3	III/2	II/2
Rated insulation voltage(V)		250	320	630
Rated surge voltage(kV)		4	4	4
General data				
Stripping length(mm)		6-7		
Screw thread		M3		
Tightening torque(Nm)		0.5-0.6		
Insulation material group		PA 66 I V0		



MAFD500 Pitch 5.0mm
Poles 2p~24p
Connection point down type, with screw flange

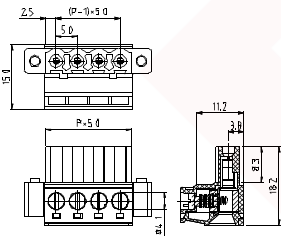

MAFT500 Pitch 5.0mm
Poles 2p~24p
Connection point up type, with screw flange

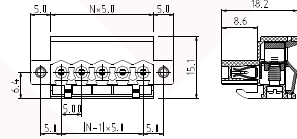

MBFR500 Pitch 5.0mm
Poles 2p~24p
Plug, hook on entry side, with screw flange

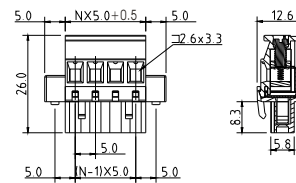

MBFW500 Pitch 5.0mm
Poles 2p~24p
Plug, hook on back side, with screw flange

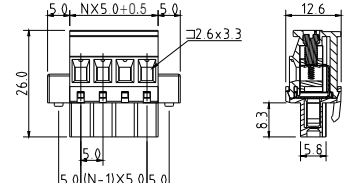

Technical data				
Approval				
Technical data(UL/cUL)	Use Group	B	C	D
Nominal voltage (V)		300	-	300
Nominal current (A)		15	-	10
Connection capacity(AWG)		30-12	-	30-12
Technical data in accordance with IEC and VDE				
Rated insulation voltage at pollution degree 2 (V)			320	
Rated current/conductor cross-section (A/mm ²)			12/2.5	
Solid/stranded(mm ²)		0.2-2.5/0.2-2.5		
Surge voltage category/pollution degree		III/3	III/2	II/2
Rated insulation voltage(V)		250	320	630
Rated surge voltage(kV)		4	4	4
General data				
Stripping length(mm)		7-8		
Screw thread		M3		
Tightening torque(Nm)		0.5-0.6		
Insulation material group		PA 66 I V0		

Technical data				
Approval				
Technical data(UL/cUL)	Use Group	B	C	D
Nominal voltage (V)		300	-	300
Nominal current (A)		15	-	10
Connection capacity(AWG)		30-12	-	30-12
Technical data in accordance with IEC				
Rated insulation voltage at pollution degree 2 (V)			320	
Rated current/conductor cross-section (A/mm ²)			12/2.5	
Solid/stranded(mm ²)		0.2-2.5/0.2-2.5		
Surge voltage category/pollution degree		III/3	III/2	II/2
Rated insulation voltage(V)		250	320	630
Rated surge voltage(kV)		4	4	4
General data				
Stripping length(mm)		7-8		
Screw thread		M3		
Tightening torque(Nm)		0.5-0.6		
Insulation material group		PA 66 I V0		

Technical data				
Approval				
Technical data(UL/cUL)	Use Group	B	C	D
Nominal voltage (V)		300	-	300
Nominal current (A)		15	-	10
Connection capacity(AWG)		30-12	-	30-12
Technical data in accordance with IEC and VDE				
Rated insulation voltage at pollution degree 2 (V)			320	
Rated current/conductor cross-section (A/mm ²)			12/2.5	
Solid/stranded(mm ²)		0.2-2.5/0.2-2.5		
Surge voltage category/pollution degree		III/3	III/2	II/2
Rated insulation voltage(V)		250	320	630
Rated surge voltage(kV)		4	4	4
General data				
Stripping length(mm)		6-7		
Screw thread		M3		
Tightening torque(Nm)		0.5-0.6		
Insulation material group		PA 66 I V0		

Technical data				
Approval				
Technical data(UL/cUL)	Use Group	B	C	D
Nominal voltage (V)		300	-	300
Nominal current (A)		15	-	10
Connection capacity(AWG)		30-12	-	30-12
Technical data in accordance with IEC and VDE				
Rated insulation voltage at pollution degree 2 (V)			320	
Rated current/conductor cross-section (A/mm ²)			12/2.5	
Solid/stranded(mm ²)		0.2-2.5/0.2-2.5		
Surge voltage category/pollution degree		III/3	III/2	II/2
Rated insulation voltage(V)		250	320	630
Rated surge voltage(kV)		4	4	4
General data				
Stripping length(mm)		6-7		
Screw thread		M3		
Tightening torque(Nm)		0.5-0.6		
Insulation material group		PA 66 I V0		



MASD508 Pitch 5.08mm
Poles 2p~24p
Connection point down type

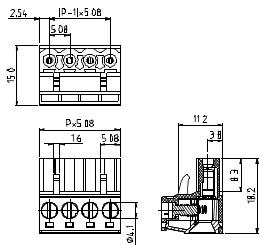

Technical data			
Approval			
Technical data(UL/cUL)	Use Group	B	C D
Nominal voltage (V)	300	-	300
Nominal current (A)	15	-	10
Connection capacity(AWG)	30-12	-	30-12
Technical data in accordance with IEC and VDE			
Rated insulation voltage at pollution degree 2 (V)	320		
Rated current/conductor cross-section (A/mm ²)	12/2.5		
Solid/stranded(mm ²)	0.2-2.5/0.2-2.5		
Surge voltage category/pollution degree	III/3	III/2	II/2
Rated insulation voltage(V)	250	320	630
Rated surge voltage(kV)	4	4	4
General data			
Stripping length(mm)	7-8		
Screw thread	M3		
Tightening torque(Nm)	0.5-0.6		
Insulation material group	PA 66 I V0		



MBSR508 Pitch 5.08mm
Poles 2p~24p
Plug, hook on entry side, without flange

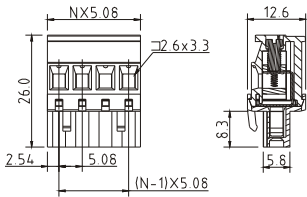

Technical data			
Approval			
Technical data(UL/cUL)	Use Group	B	C D
Nominal voltage (V)	300	-	300
Nominal current (A)	15	-	10
Connection capacity(AWG)	30-12	-	30-12
Technical data in accordance with IEC and VDE			
Rated insulation voltage at pollution degree 2 (V)	320		
Rated current/conductor cross-section (A/mm ²)	12/2.5		
Solid/stranded(mm ²)	0.2-2.5/0.2-2.5		
Surge voltage category/pollution degree	III/3	III/2	II/2
Rated insulation voltage(V)	250	320	630
Rated surge voltage(kV)	4	4	4
General data			
Stripping length(mm)	7-8		
Screw thread	M3		
Tightening torque(Nm)	0.5-0.6		
Insulation material group	PA 66 I V0		



MBSW508 Pitch 5.08mm
Poles 2p~24p
Plug, hook on back side, without flange

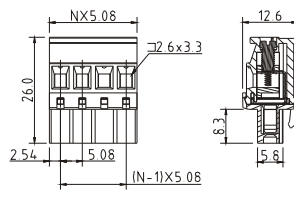

Technical data			
Approval			
Technical data(UL/cUL)	Use Group	B	C D
Nominal voltage (V)	300	-	300
Nominal current (A)	15	-	10
Connection capacity(AWG)	30-12	-	30-12
Technical data in accordance with IEC and VDE			
Rated insulation voltage at pollution degree 2 (V)	320		
Rated current/conductor cross-section (A/mm ²)	12/2.5		
Solid/stranded(mm ²)	0.2-2.5/0.2-2.5		
Surge voltage category/pollution degree	III/3	III/2	II/2
Rated insulation voltage(V)	250	320	630
Rated surge voltage(kV)	4	4	4
General data			
Stripping length(mm)	6-7		
Screw thread	M3		
Tightening torque(Nm)	0.5-0.6		
Insulation material group	PA 66 I V0		



MCSD508 Pitch 5.08mm
Poles 2p~24p
With front screw connection

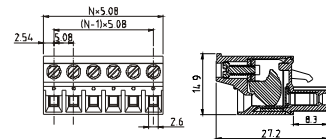

Technical data			
Approval			
Technical data(UL/cUL)	Use Group	B	C D
Nominal voltage (V)	300	-	300
Nominal current (A)	15	-	10
Connection capacity(AWG)	22-12	-	22-12
Technical data in accordance with IEC			
Rated insulation voltage at pollution degree 2 (V)	320		
Rated current/conductor cross-section (A/mm ²)	12/2.5		
Solid/stranded(mm ²)	0.5-2.5/0.5-2.5		
Surge voltage category/pollution degree	III/3	III/2	II/2
Rated insulation voltage(V)	250	320	630
Rated surge voltage(kV)	4	4	4
General data			
Stripping length(mm)	8-9		
Screw thread	M2.5		
Tightening torque(Nm)	0.4-0.5		
Insulation material group	PA 66 I V0		



MAFD508 Pitch 5.08mm
Poles 2p~24p
Connection point down type, with screw flange

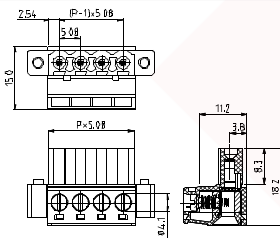

Technical data			
Approval			
Technical data(UL/cUL)	Use Group	B	C D
Nominal voltage (V)	300	-	300
Nominal current (A)	15	-	10
Connection capacity(AWG)	30-12	-	30-12
Technical data in accordance with IEC and VDE			
Rated insulation voltage at pollution degree 2 (V)	320		
Rated current/conductor cross-section (A/mm ²)	12/2.5		
Solid/stranded(mm ²)	0.2-2.5/0.2-2.5		
Surge voltage category/pollution degree	III/3	III/2	II/2
Rated insulation voltage(V)	250	320	630
Rated surge voltage(kV)	4	4	4
General data			
Stripping length(mm)	7-8		
Screw thread	M3		
Tightening torque(Nm)	0.5-0.6		
Insulation material group	PA 66 I V0		



MBFR508 Pitch 5.08mm
Poles 2p~24p
Plug, hook on entry side, with screw flange

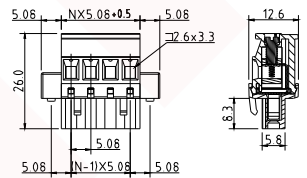

Technical data			
Approval			
Technical data(UL/cUL)	Use Group	B	C D
Nominal voltage (V)	300	-	300
Nominal current (A)	15	-	10
Connection capacity(AWG)	30-12	-	30-12
Technical data in accordance with IEC and VDE			
Rated insulation voltage at pollution degree 2 (V)	320		
Rated current/conductor cross-section (A/mm ²)	12/2.5		
Solid/stranded(mm ²)	0.2-2.5/0.2-2.5		
Surge voltage category/pollution degree	III/3	III/2	II/2
Rated insulation voltage(V)	250	320	630
Rated surge voltage(kV)	4	4	4
General data			
Stripping length(mm)	7-8		
Screw thread	M3		
Tightening torque(Nm)	0.5-0.6		
Insulation material group	PA 66 I V0		



MBFW508 Pitch 5.08mm
Poles 2p~24p
Plug, hook on back side, with screw flange

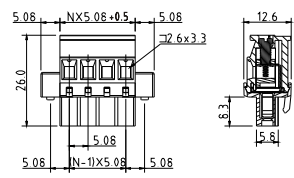

Technical data			
Approval			
Technical data(UL/cUL)	Use Group	B	C D
Nominal voltage (V)	300	-	300
Nominal current (A)	15	-	10
Connection capacity(AWG)	30-12	-	30-12
Technical data in accordance with IEC and VDE			
Rated insulation voltage at pollution degree 2 (V)	320		
Rated current/conductor cross-section (A/mm ²)	12/2.5		
Solid/stranded(mm ²)	0.2-2.5/0.2-2.5		
Surge voltage category/pollution degree	III/3	III/2	II/2
Rated insulation voltage(V)	250	320	630
Rated surge voltage(kV)	4	4	4
General data			
Stripping length(mm)	6-7		
Screw thread	M3		
Tightening torque(Nm)	0.5-0.6		
Insulation material group	PA 66 I V0		



MCFD508 Pitch 5.08mm
Poles 2p~24p
With front screw connection

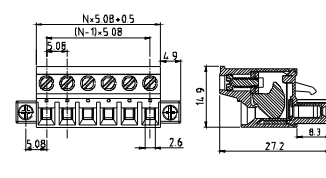

Technical data			
Approval			
Technical data(UL/cUL)	Use Group	B	C D
Nominal voltage (V)	300	-	300
Nominal current (A)	15	-	10
Connection capacity(AWG)	22-12	-	22-12
Technical data in accordance with IEC			
Rated insulation voltage at pollution degree 2 (V)	320		
Rated current/conductor cross-section (A/mm ²)	12/2.5		
Solid/stranded(mm ²)	0.5-2.5/0.5-2.5		
Surge voltage category/pollution degree	III/3	III/2	II/2
Rated insulation voltage(V)	250	320	630
Rated surge voltage(kV)	4	4	4
General data			
Stripping length(mm)	8-9		
Screw thread	M2.5		
Tightening torque(Nm)	0.4-0.5		
Insulation material group	PA 66 I V0		



MESO508 Pitch 5.08mm
Poles 2p~24p
Plug-in direction 45D to the conductor axis

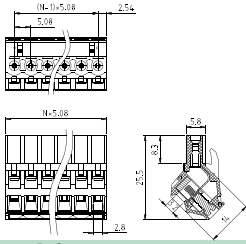

Technical data

Approval **ULus**

Technical data(UL/cUL)	Use Group	B	C	D
Nominal voltage (V)		300	-	300
Nominal current (A)		15	-	10
Connection capacity(AWG)		30-12	-	30-12
Technical data in accordance with IEC				
Rated insulation voltage at pollution degree 2 (V)		320		
Rated current/conductor cross-section (A/mm ²)		12/2.5		
Solid/stranded(mm ²)		0.2-2.5/0.2-2.5		
Surge voltage category/pollution degree		III/3	III/2	II/2
Rated insulation voltage(V)		250	320	630
Rated surge voltage(kV)		4	4	4
General data				
Stripping length(mm)		7-8		
Screw thread		M3		
Tightening torque(Nm)		0.5-0.6		
Insulation material group		PA 66 I V0		



MEFO508 Pitch 5.08mm
Poles 2p~24p
Plug-in direction 45D to the conductor axis

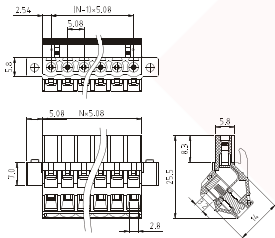

Technical data

Approval **ULus**

Technical data(UL/cUL)	Use Group	B	C	D
Nominal voltage (V)		300	-	300
Nominal current (A)		15	-	10
Connection capacity(AWG)		30-12	-	30-12
Technical data in accordance with IEC				
Rated insulation voltage at pollution degree 2 (V)		320		
Rated current/conductor cross-section (A/mm ²)		12/2.5		
Solid/stranded(mm ²)		0.2-2.5/0.2-2.5		
Surge voltage category/pollution degree		III/3	III/2	II/2
Rated insulation voltage(V)		250	320	630
Rated surge voltage(kV)		4	4	4
General data				
Stripping length(mm)		7-8		
Screw thread		M3		
Tightening torque(Nm)		0.5-0.6		
Insulation material group		PA 66 I V0		

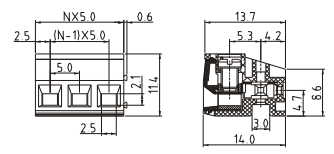
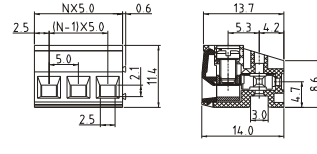
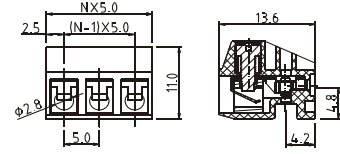
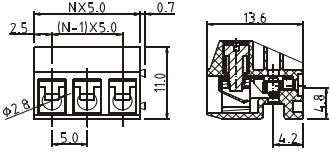
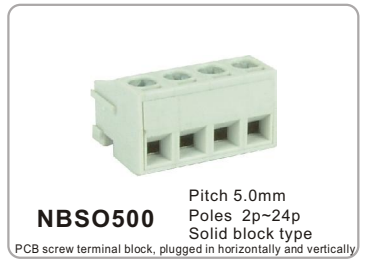

Technical data			
Approval (Pending)			
Technical data(UL/cUL)	Use Group	B	C D
Nominal voltage (V)		300	- 300
Nominal current (A)		14	- 10
Connection capacity(AWG)		22-14	- 22-14
Technical data in accordance with IEC and VDE			
Rated insulation voltage at pollution degree 2 (V)		320	
Rated current/conductor cross-section (A/mm ²)		12/1.5	
Solid/stranded(mm ²)		0.34-1.5/0.34-1.5	
Surge voltage category/pollution degree		III/3	III/2 II/2
Rated insulation voltage(V)		250	320 630
Rated surge voltage(kV)		2.5	2.5 2.5
General data			
Stripping length(mm)		5-6	
Screw thread		M2.6	
Tightening torque(Nm)		0.4-0.45	
Insulation material group		PA 66 I V0	

Technical data			
Approval (Pending)			
Technical data(UL/cUL)	Use Group	B	C D
Nominal voltage (V)		300	- 300
Nominal current (A)		14	- 10
Connection capacity(AWG)		22-14	- 22-14
Technical data in accordance with IEC and VDE			
Rated insulation voltage at pollution degree 2 (V)		320	
Rated current/conductor cross-section (A/mm ²)		12/1.5	
Solid/stranded(mm ²)		0.34-1.5/0.34-1.5	
Surge voltage category/pollution degree		III/3	III/2 II/2
Rated insulation voltage(V)		250	320 630
Rated surge voltage(kV)		2.5	2.5 2.5
General data			
Stripping length(mm)		5-6	
Screw thread		M2.6	
Tightening torque(Nm)		0.4-0.45	
Insulation material group		PA 66 I V0	

Technical data			
Approval			
Technical data(UL/cUL)	Use Group	B	C D
Nominal voltage (V)		300	- 300
Nominal current (A)		10	- 10
Connection capacity(AWG)		26-16	- 26-16
Technical data in accordance with IEC			
Rated insulation voltage at pollution degree 2 (V)		320	
Rated current/conductor cross-section (A/mm ²)		8/1.5	
Solid/stranded(mm ²)		0.34-1.5/0.34-1.5	
Surge voltage category/pollution degree		III/3	III/2 II/2
Rated insulation voltage(V)		250	320 630
Rated surge voltage(kV)		2.5	2.5 2.5
General data			
Stripping length(mm)		5-6	
Screw thread		M3	
Tightening torque(Nm)		0.4-0.45	
Insulation material group		PA 66 I V0	

Technical data			
Approval			
Technical data(UL/cUL)	Use Group	B	C D
Nominal voltage (V)		300	- 300
Nominal current (A)		10	- 10
Connection capacity(AWG)		26-16	- 26-16
Technical data in accordance with IEC			
Rated insulation voltage at pollution degree 2 (V)		320	
Rated current/conductor cross-section (A/mm ²)		8/1.5	
Solid/stranded(mm ²)		0.34-1.5/0.34-1.5	
Surge voltage category/pollution degree		III/3	III/2 II/2
Rated insulation voltage(V)		250	320 630
Rated surge voltage(kV)		2.5	2.5 2.5
General data			
Stripping length(mm)		5-6	
Screw thread		M3	
Tightening torque(Nm)		0.4-0.45	
Insulation material group		PA 66 I V0	

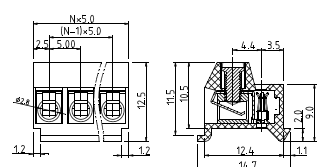
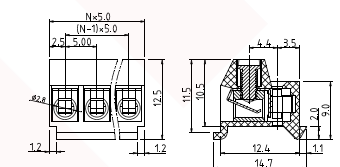
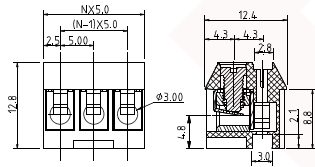

Technical data			
Approval (Pending)			
Technical data(UL/cUL)	Use Group	B	C D
Nominal voltage(V)		300	- 300
Nominal current(A)		10	- 10
Connection capacity(AWG)		26-12	- 26-12
Technical data in accordance with IEC			
Rated insulation voltage at pollution degree 2 (V)		320	
Rated current/conductor cross-section (A/mm ²)		10/2.5	
Solid/stranded(mm ²)		0.2-2.5/0.2-2.5	
Surge voltage category/pollution degree		III/3	III/2 II/2
Rated insulation voltage(V)		250	320 630
Rated surge voltage(kV)		4	4 4
General data			
Stripping length(mm)		6-7	
Screw thread		M3	
Tightening torque(Nm)		0.4-0.5	
Insulation material group		PA 66 I V0	

Technical data			
Approval			
Technical data(UL/cUL)	Use Group	B	C D
Nominal voltage(V)		300	- -
Nominal current(A)		10	- -
Connection capacity(AWG)		26-14	- -
Technical data in accordance with IEC			
Rated insulation voltage at pollution degree 2 (V)		320	
Rated current/conductor cross-section (A/mm ²)		10/2.5	
Solid/stranded(mm ²)		0.2-2.5/0.2-2.5	
Surge voltage category/pollution degree		III/3	III/2 II/2
Rated insulation voltage(V)		250	320 630
Rated surge voltage(kV)		4	4 4
General data			
Stripping length(mm)		6-7	
Screw thread		M2.6	
Tightening torque(Nm)		0.4-0.45	
Insulation material group		PA 66 I V0	

Technical data			
Approval			
Technical data(UL/cUL)	Use Group	B	C D
Nominal voltage(V)		300	- 300
Nominal current(A)		10	- 10
Connection capacity(AWG)		26-14	- 26-14
Technical data in accordance with IEC			
Rated insulation voltage at pollution degree 2 (V)		320	
Rated current/conductor cross-section (A/mm ²)		10/2.5	
Solid/stranded(mm ²)		0.2-2.5/0.2-2.5	
Surge voltage category/pollution degree		III/3	III/2 II/2
Rated insulation voltage(V)		250	320 630
Rated surge voltage(kV)		4	4 4
General data			
Stripping length(mm)		6-7	
Screw thread		M2.6	
Tightening torque(Nm)		0.4-0.45	
Insulation material group		PA 66 I V0	

Technical data			
Approval			
Technical data(UL/cUL)	Use Group	B	C D
Nominal voltage(V)		300	- 300
Nominal current(A)		10	- 10
Connection capacity(AWG)		26-14	- 26-14
Technical data in accordance with IEC			
Rated insulation voltage at pollution degree 2 (V)		320	
Rated current/conductor cross-section (A/mm ²)		10/2.5	
Solid/stranded(mm ²)		0.2-2.5/0.2-2.5	
Surge voltage category/pollution degree		III/3	III/2 II/2
Rated insulation voltage(V)		250	320 630
Rated surge voltage(kV)		4	4 4
General data			
Stripping length(mm)		6-7	
Screw thread		M2.6	
Tightening torque(Nm)		0.4-0.45	
Insulation material group		PA 66 I V0	